

**GENERAL NOTES:**

1. THIS DRAWING IS THE PROPERTY OF WS Atkins & PARTNERS OVERSEAS (HEREIN "THE ENGINEER") AND IS NOT TO BE REPRODUCED OR USED WITHOUT THE WRITTEN CONSENT OF THE ENGINEER.
2. DO NOT SCALE FROM THE DRAWING.
3. ALL DIMENSIONS ARE IN METERS AND LEVELS IN METERS UNLESS SPECIFICALLY STATED OTHERWISE TO BE IN FEET AND INCHES APPROVED BY THE ENGINEER.
4. THIS DRAWING SHOULD BE READ IN CONJUNCTION WITH OTHER RELEVANT ARCHITECTURAL, STRUCTURAL, ELECTRICAL, MECHANICAL, PLUMBING AND ALL RELEVANT SECTIONS OF THE PROJECT.

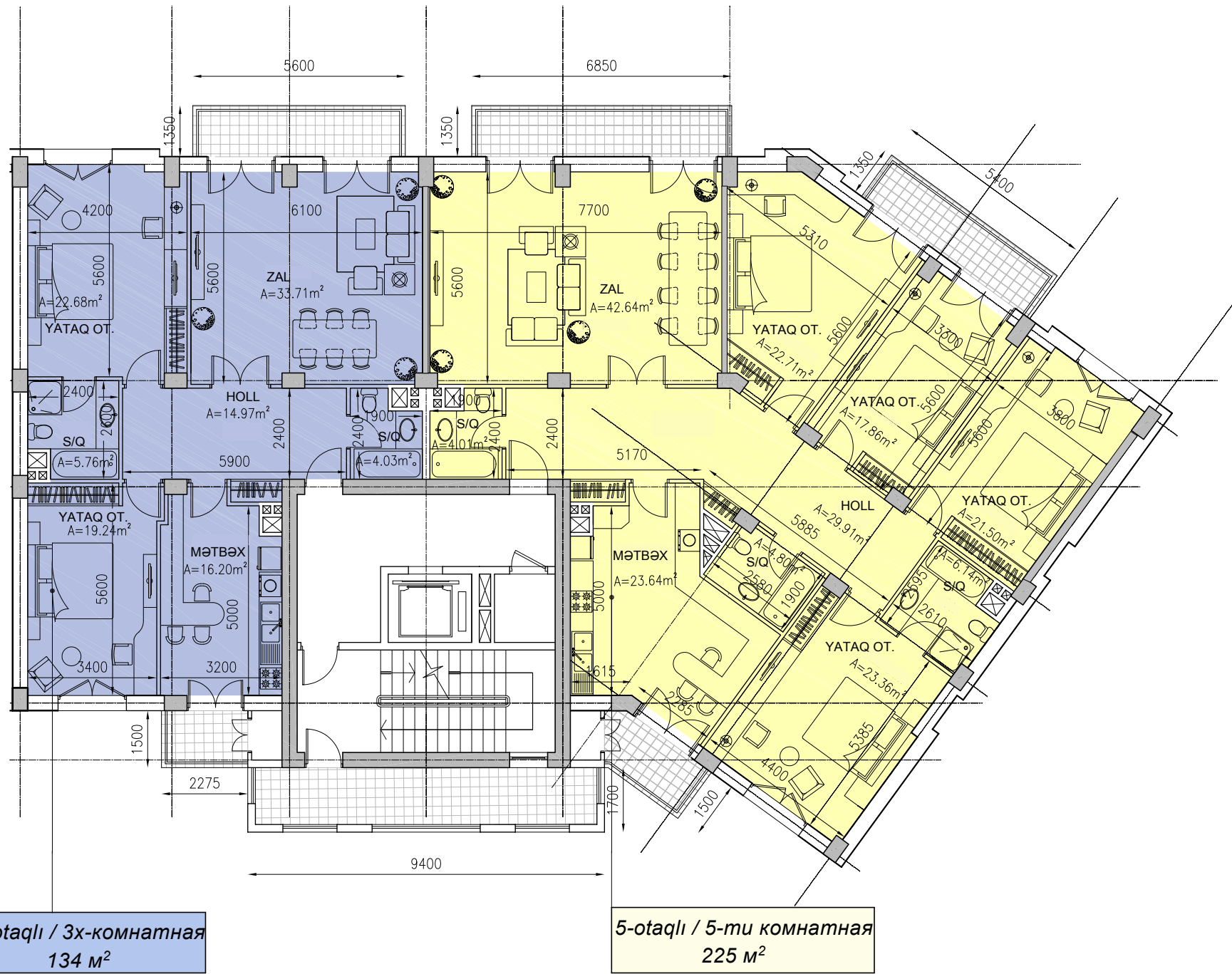
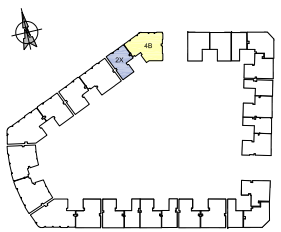

**3-otaqlı / 3x-комнатная**  
**134 m<sup>2</sup>**

**5-otaqlı / 5-ми комнатная**  
**225 m<sup>2</sup>**

| Rev | Description | Drawn | Checked | Authorised |
|-----|-------------|-------|---------|------------|
|     |             |       |         |            |
|     |             |       |         |            |
|     |             |       |         |            |
|     |             |       |         |            |
|     |             |       |         |            |
|     |             |       |         |            |

| FOR APPROVAL     | A   | 14.08.13 | ATA        |
|------------------|-----|----------|------------|
| Purpose of issue | Rev | Date     | Authorised |
|                  |     |          |            |
|                  |     |          |            |
|                  |     |          |            |

**TYPICAL BUILDING**  
**WHITE CITY - BAKU - AZERBAIJAN**  
**PLOT BW22**

Client:  
**BAKU WHITE CITY**

Consultant:  
**WS Atkins & Partners Overseas**  
HUALI BIN AL-KAWAN ROAD TELEPHONE: +971 4445 8000  
 P.O. BOX 9563, DUBAI FAX: +971 4445 9000  
 UNITED ARAB EMIRATES EMAIL: [atkins.dubai@atkins.com](mailto:atkins.dubai@atkins.com)

Drawing title:  
**PLOT BW22**  
**TYPICAL FLOOR PART PLAN**  
**( 9 of 13 )**

| Original Scale | Drawn          | Checked        | Authorised     | Size |
|----------------|----------------|----------------|----------------|------|
|                | AG             | CA             | SH             | A1   |
| 1:50           | Date: 11.06.13 | Date: 24.06.13 | Date: 24.06.13 |      |

| Drawing Number      | Rev |
|---------------------|-----|
| 5083407/A/BW22/1059 | A   |